

**ITEM 22. MOBILE CRANES – TEMPORARY ROAD CLOSURES – WEMYSS  
LANE SURRY HILLS**

**TRIM RECORD NO: 2017/411018**

**RECOMMENDATION**

It is recommended that the Committee endorse the temporary road closure of the north-south section of Wemyss Lane, Surry Hills, between Goulburn Street and the east-west section of Wemyss Lane, on Wednesday 1 November 2017 to Monday 6 November 2017 from 8am to 5pm, subject to the following conditions:

- (A) The Applicant must comply with the temporary road closure conditions as mentioned in Schedule B of this Agenda.
- (B) The Applicant must comply with any other conditions imposed by City's Construction Regulation Unit.
- (C) The Applicant has indicated Tuesday 7 November 2017 to Sunday 12 November 2017 as alternative dates in case of inclement weather.
- (D) The Applicant must contact Surry Hills Police to obtain a separate police permit and to discuss deployment of user pay police for the road closure.
- (E) The Applicant must provide a telephone number of the supervisor responsible for the proposed closure and include contact details in the notification letters to be distributed to affected stakeholders.

**VOTING MEMBERS FOR THIS ITEM**

<b><i>Voting Members</i></b>	<b><i>Support</i></b>	<b><i>Object</i></b>
City of Sydney		
Roads and Maritime Services		
NSW Police – Surry Hills LAC		
Representative for the Member for Sydney		

**DECISION**

**BACKGROUND**

Cubic Construction Management has applied for the temporary road closure of the north-south section of Wemyss Lane, Surry Hills, between Goulburn Street and the east-west section of Wemyss Lane on Wednesday 1 November 2017 to Monday 6 November 2017 from 8am to 5pm.

**COMMENTS**

The proposed temporary road closure is required to allow a mobile crane to install hoarding in Wemyss Lane, Surry Hills.

The Applicant has provided a site-specific Traffic Control Plan that includes details of barricades, signs, flagmen and other traffic devices to implement the proposed road closure.

There are currently no other approved temporary road closures proposed to take place on the same day in close proximity of this closure.

The temporary road closure will not affect any other properties, as local access will be provided at all times and alternative access routes are available nearby.

A Traffic Management Plan (TMP) for the temporary road closure was approved by Roads and Maritime Services (RMS).

### **CONSULTATION**

The Applicant will be required to notify affected stakeholders as stipulated in Schedule B.

### **FINANCIAL**

All costs associated with the proposed closure will be borne by the Applicant.



### **ATTACHMENTS**

Mobile Cranes – Temporary Road Closures – Wemyss Lane, Surry Hills

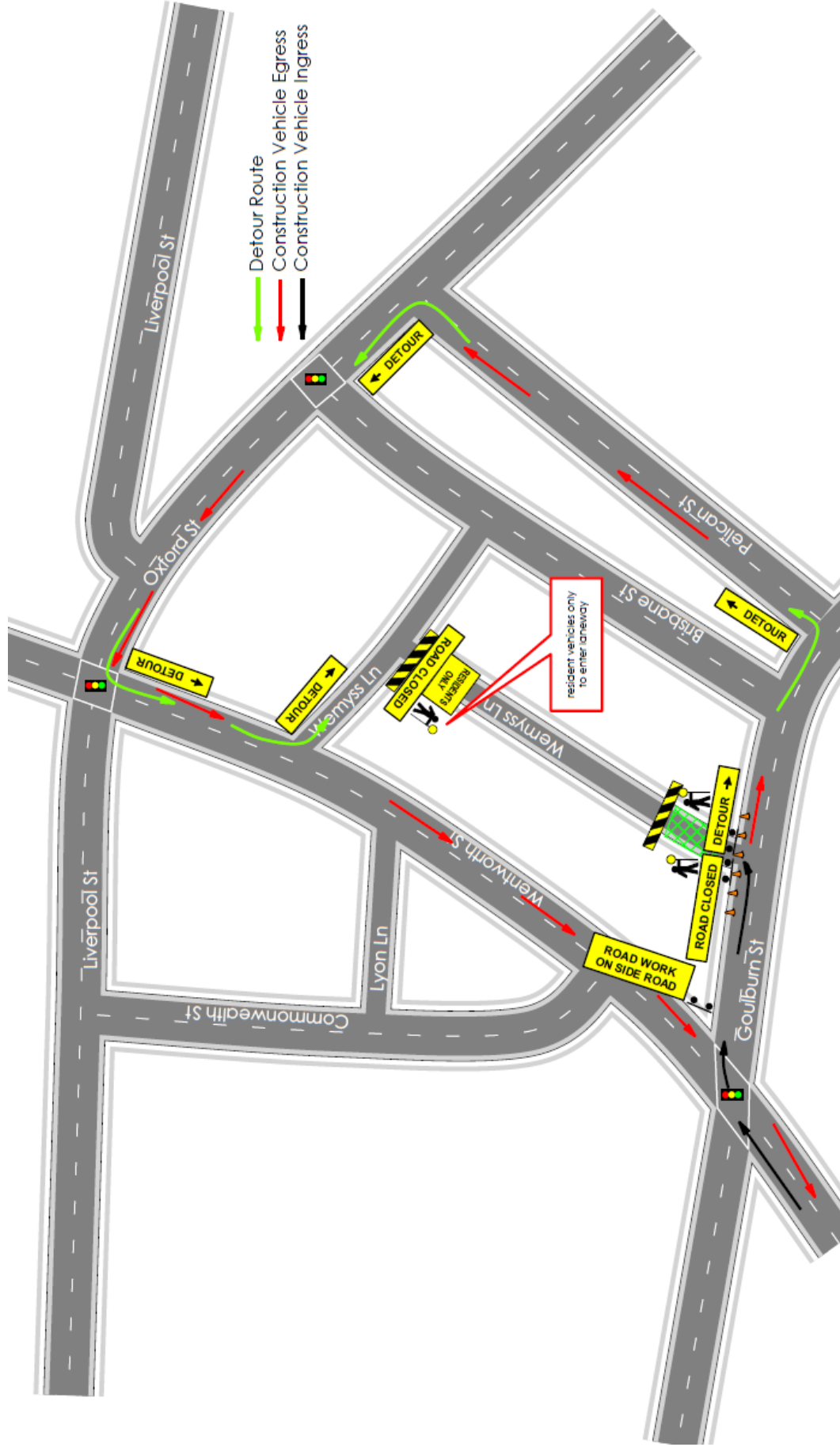
Claudia Calabro, Traffic Works Coordinator



→ Detour Route  
→ Construction Vehicle Egress  
→ Construction Vehicle Ingress

Drawing: Justin Ebery PWZTMP #: 0086801644 Exp: 17/02/20 Drawn on: 28/04/17		Site Specific Notes: 		Work Location: Wemyss Lane Sury Hills Plan # North					
Drawing: AMW 45 1742.3 2009 & 10A103 V4 2010		Compliance Notes: 1. This plan is not to scale 2. A or B size signs are to be used 3. All signs are to be used 4. Cone spacing is to be 10m 5. Appropriate PPE is to be worn for the conditions 6. Traffic Controllers to use radios when verbal communication is required 7. Signs to be placed to be noted 8. All signs subject to 25% - 10% tolerances 9. Sign Checks are required every hour 10. Any active Traffic Controller to have escape route and 1.5D sight distance at their location 11. Drawn AMW 45 1742.3 2009 & 10A103 V4 2010		Modifications are to be marked on the plan. Only Current Red/Orange/PWZTMP card holders can amend TGS.		Competency # _____ Expiry _____ Name _____ Sign _____			
Sign Spacing's	Estimated spacing of Traffic St	Dimension of sign 'm'	0-5	15-50	60	70	80	90	100

